

08/06/2023

CONTRACT: **DA00504** WBS #.: **2022CPT.01.10.20281.1, ETC.**

CONTRACT: **DA00504**

*****SYSTEMS*****
*****CONTRACT*****
*****PERMITS*****
*****SERIALS*****

STATE OF NORTH CAROLINA
DIVISION OF HIGHWAYS

DARE COUNTY

STATE	STATE PROJECT NUMBER OR	SHEET
N.C.	2022CPT.01.10.20281.1, ETC.	1
STATE FUNDING		DESCRIPTION
2022CPT.01.10.20281.1		PE, CONST

LOCATION:

- MAP #5 - SR 1205 FROM NC 12 TO DEAD END
- MAP #10 - SR 1249 FROM US 158 TO NC 12
- MAP #24 - SR 1480 FROM DEAD END TO US 158

TYPE OF WORK:

MILLING, RESURFACING & SHOULDER RECONSTRUCTION

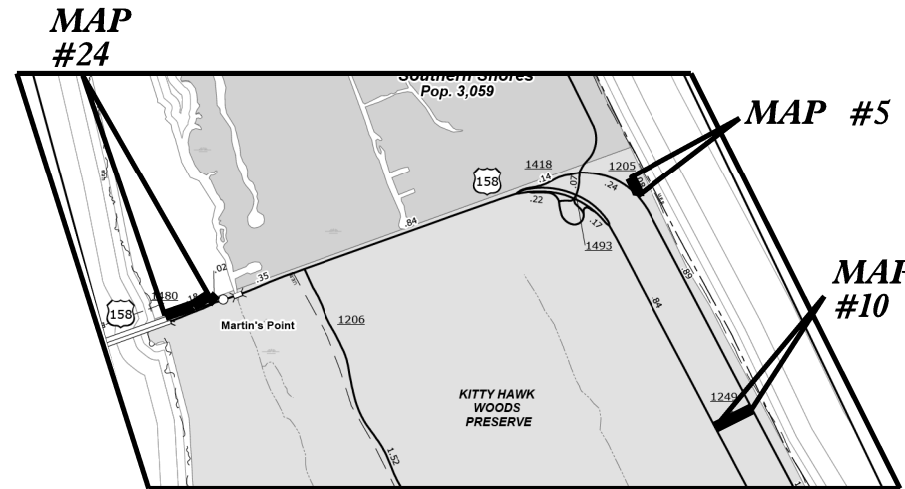

GRAPHIC SCALES

NTS

MAP LENGTHS

- MAP #5 = 0.08 MILES
- MAP #10 = 0.15 MILES
- MAP #24 = 0.20 MILES

Present in the Office of:
DIVISION OF HIGHWAYS
113 Airport Dr., Edenton NC, 27932

2018 STANDARD SPECIFICATIONS

W. B. HOBBS, PE
DIVISION PROJECT TEAM LEAD

CHRIS SLACHTA
DIVISION PROPOSALS ENGINEER

S. P. FENWICK, PLS
DIVISION DESIGN ENGINEER



STATE	STATE PROJECT REFERENCE NO.	SHEET NO.
N.C.	2022CPT.01.10.20281.1, ETC.	2
STATE PROJ. NO.		DESCRIPTION
2022CPT.01.10.20281.1		PE, CONST
2022CPT.01.10.20282.1		PE, CONST

STATE OF NORTH CAROLINA
DIVISION OF HIGHWAYS

DARE COUNTY

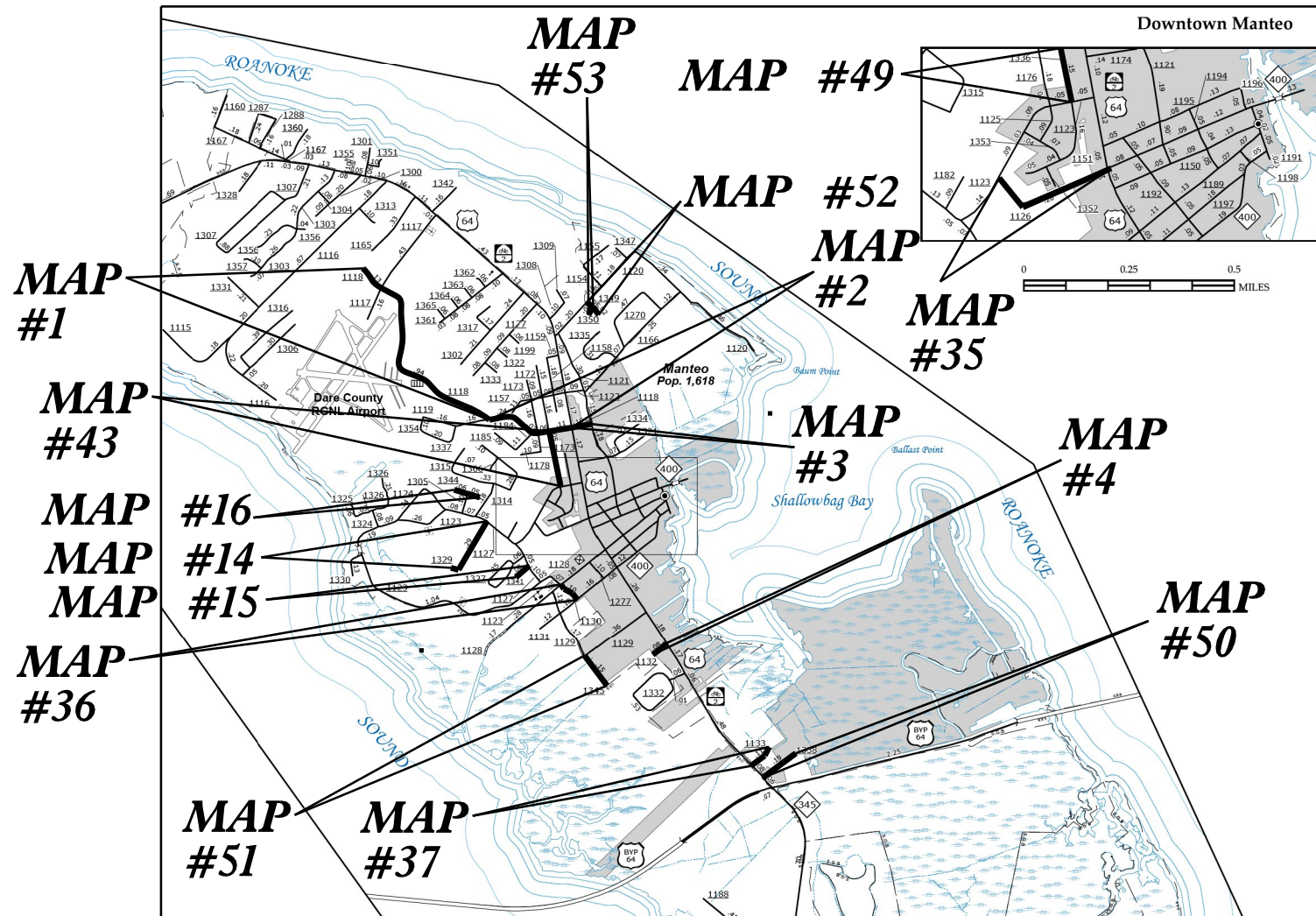

LOCATION:

- MAP #1 - SR 1118 (DRIFTWOOD DR) FROM END OF MAINTENANCE TO SR 1118 (HARRIOT ST)
- MAP #2 - SR 1118 (HARRIOT ST) FROM SR 1118 (DRIFTWOOD DR) TO US 64
- MAP #3 - SR 1118 (HARRIOT ST) FROM US 64 TO SR 1121
- MAP #4 - SR 1132 FROM DEAD END TO US 64/264
- MAP #14 - SR 1329 FROM CUL DE SAC TO SR 1123
- MAP #15 - SR 1341 FROM DEAD END TO SR 1127
- MAP #16 - SR 1344 FROM CUL DE SAC TO DEAD END
- MAP #35 - SR 1126 FROM SR 1123 TO US 64
- MAP #36 - SR 1130 FROM SR 1131 TO SR 1128
- MAP #37 - SR 1133 FROM US 64 TO DEAD END
- MAP #43 - SR 1176 FROM SR 1123 TO SR 1118
- MAP #49 - SR 1336 FROM SR 1123 TO DEAD END
- MAP #50 - SR 1338 FROM US 63 TO END OF MAINTENANCE
- MAP #51 - SR 1345 FROM END OF MAINTENANCE TO SR 1129
- MAP #52 - SR 1349 FROM SR 1120 TO CUL DE SAC
- MAP #53 - SR 1350 FROM CUL DE SAC TO SR 1349

TYPE OF WORK:

MILLING, RESURFACING, SHOULDER RECONSTRUCTION, & THIN LIFT

CONTRACT: DA00504 WBS #: 2022CPT.01.10.20281.1, ETC.

23-NOV-2021 12:05 S:\Contract\61\Proposed Resurfacing\DA00504-Dare Secondary & Thin-Lift\Design Files\DA00504_DL_ddc_tshl-5.dgn \$\$\$USERNAME\$\$\$

GRAPHIC SCALES

NTS

MAP LENGTH

- MAP #1 = 1.04 MILES
- MAP #2 = 0.42 MILES
- MAP #3 = 0.09 MILES
- MAP #4 = 0.08 MILES
- MAP #14 = 0.29 MILES
- MAP #15 = 0.08 MILES
- MAP #16 = 0.12 MILES
- MAP #35 = 0.30 MILES
- MAP #36 = 0.07 MILES
- MAP #37 = 0.09 MILES
- MAP #43 = 0.25 MILES
- MAP #49 = 0.15 MILES
- MAP #50 = 0.18 MILES
- MAP #51 = 0.14 MILES
- MAP #52 = 0.07 MILES
- MAP #53 = 0.03 MILES

Prepared in the Office of:
DIVISION OF HIGHWAYS

113 Airport Dr., Edenton NC, 27932

2018 STANDARD SPECIFICATIONS

W. B. HOBBS, PE
DIVISION PROJECT TEAM LEAD

CHRIS SLACHTA
DIVISION PROPOSALS ENGINEER

S. P. FENWICK, PLS
DIVISION DESIGN ENGINEER

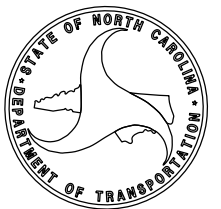

CONTRACT: DA00504 WBS #: 2022CPT.01.10.20281.1, ETC.

STATE OF NORTH CAROLINA
DIVISION OF HIGHWAYS

DARE COUNTY

STATE	STATE PROJECT REFERENCE NO.	SHEET NO.
N.C.	2022CPT.01.10.20281.1, ETC.	3
STATE PROJ. NO.		DESCRIPTION
2022CPT.10.01.20281.1		PE, CONST
2022CPT.10.01.20282.1		PE, CONST

- LOCATION:
- | | |
|--|--|
| MAP #6 - SR 1206 FROM US 158 TO NC 12 | MAP #40 - SR 1156 FROM SR 1100 TO SR 1152 |
| MAP #7 - SR 1213 FROM END OF MAINTENANCE TO SR 1214 | MAP #41 - SR 1164 FROM DEAD END TO US 264 |
| MAP #8 - SR 1217 FROM US 158 TO NC 12 | MAP #65 - SR 1549 FROM SR 1551 TO SR 1491 |
| MAP #11 - SR 1274 FROM SR 1275 TO END OF MAINTENANCE | MAP #66 - SR 1550 FROM CUL DE SAC TO SR 1549 |
| MAP #12 - SR 1275 FROM US 158 TO NC 12 | MAP #67 - SR 1551 FROM SR 1552 TO SR 1549 |
| MAP #22 - SR 1463 FROM DURHAM ST TO DEAD END | MAP #68 - SR 1552 FROM CUL DE SAC TO SR 1551 |
| MAP #38 - SR 1152 FROM DEAD END TO DEAD END | MAP #69 - SR 1553 FROM CUL DE SAC TO SR 1551 |

TYPE OF WORK: MILLING, RESURFACING, SHOULDER RECONSTRUCTION, & THIN LIFT

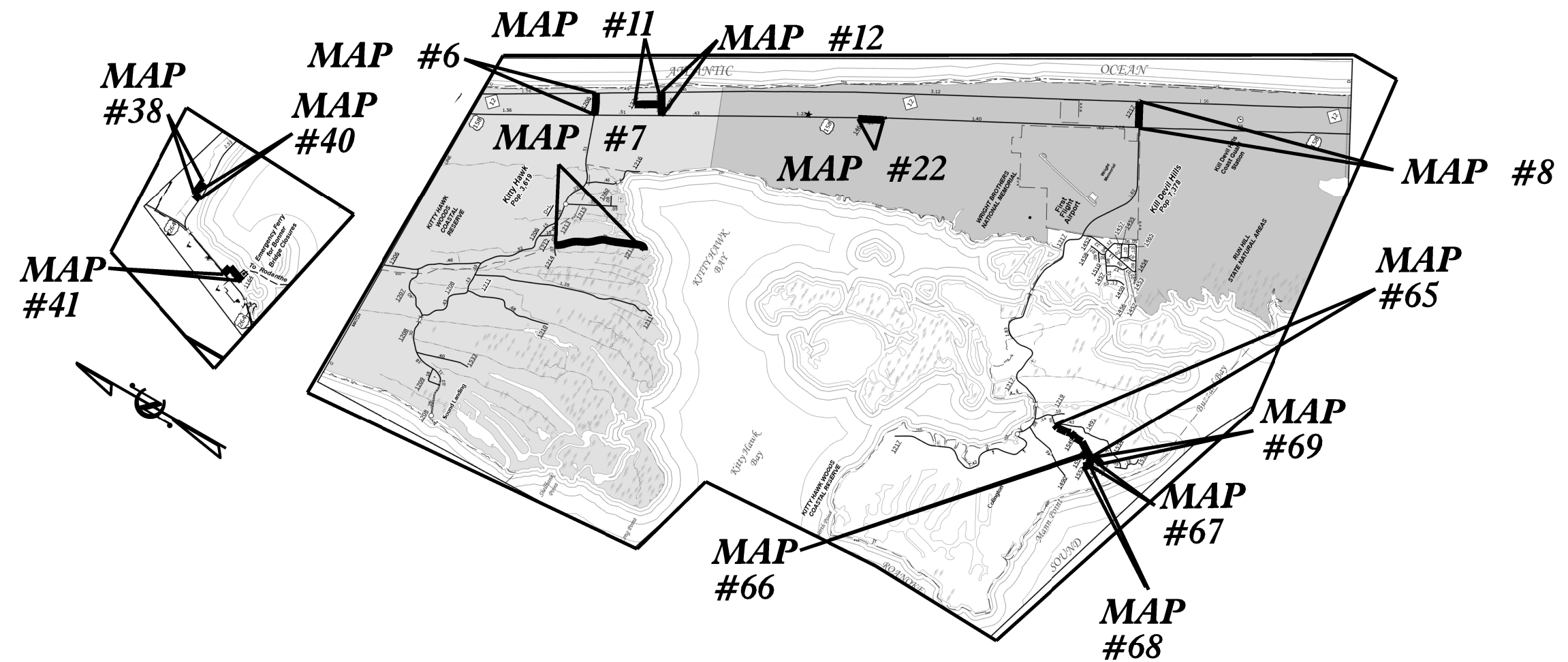

GRAPHIC SCALES

NTS

MAP LENGTH

MAP #6 = 0.17 MILES	MAP #40 = 0.04 MILES
MAP #7 = 0.62 MILES	MAP #41 = 0.19 MILES
MAP #8 = 0.19 MILES	MAP #65 = 0.37 MILES
MAP #11 = 0.19 MILES	MAP #66 = 0.05 MILES
MAP #12 = 0.17 MILES	MAP #67 = 0.05 MILES
MAP #22 = 0.24 MILES	MAP #68 = 0.04 MILES
MAP #38 = 0.07 MILES	MAP #69 = 0.10 MILES

Prepared in the Office of:
DIVISION OF HIGHWAYS
113 Airport Dr., Edenton NC, 27932

2018 STANDARD SPECIFICATIONS

W. B. HOBBS, PE
DIVISION PROJECT TEAM LEAD

CHRIS SLACHTA
DIVISION PROPOSALS ENGINEER

S. P. FENWICK, PLS
DIVISION DESIGN ENGINEER

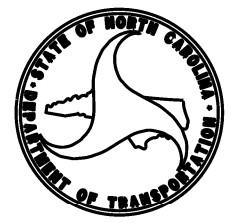

\$\$\$\$\$ SYSTEM \$\$\$\$\$\$
\$\$\$\$\$ DGN \$\$\$\$\$\$
\$\$\$\$\$ USERNAME \$\$\$\$\$\$

23-NOV-2021 12:08
 S:\Contract\61\Proposed Resurfacing\DA00504-Dare Secondary & Thin-Lift\Design Files\DA00504_DL_dcc_tshl-5.dgn
 \$\$\$USERNAME\$\$\$

CONTRACT: DA00504 **WBS #.: 2022CPT.01.10.20281.1, ETC.**

STATE OF NORTH CAROLINA
 DIVISION OF HIGHWAYS

DARE COUNTY

STATE	STATE PROJECT REFERENCE NO.	SHEET NO.
N.C.	2022CPT.01.10.20281.1, ETC.	4
STATE PROJ. NO.		DESCRIPTION
2022CPT.01.10.20282.1		PE, CONST

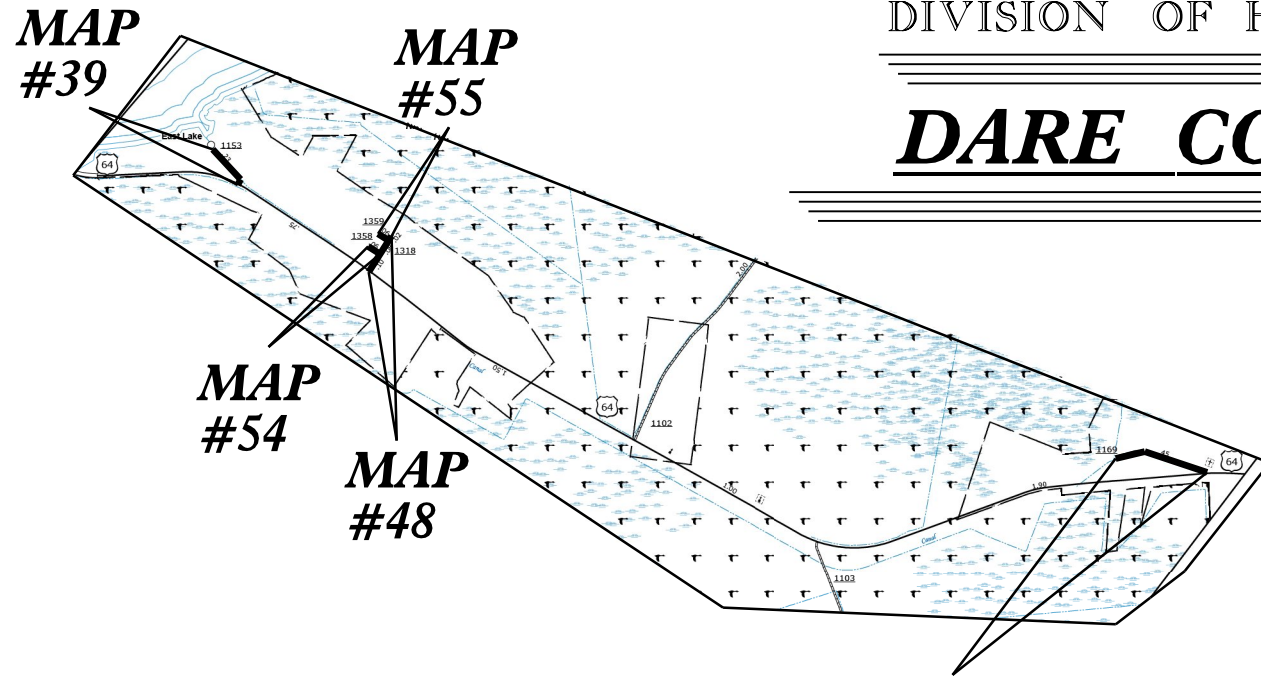

MAP #42

- LOCATION:**
- MAP #39 - SR 1153 FROM END OF PAVEMENT TO US 64
 - MAP #42 - SR 1169 FROM DEAD END TO US 64
 - MAP #44 - SR 1229 FROM SR 1224 TO CUL DE SAC
 - MAP #47 - SR 1299 FROM CUL DE SAC TO NC 12
 - MAP #48 - SR 1318 FROM US 64 TO DEAD END
 - MAP #54 - SR 1358 FROM CUL DE SAC TO SR 1318
 - MAP #55 - SR 1359 FROM CUL DE SAC TO SR 1318
 - MAP #57 - SR 1466 FROM CUL DE SAC TO SR 1226
 - MAP #58 - SR 1503 FROM SR 1226 TO END OF MAINTENANCE
 - MAP #61 - SR 1517 FROM SR 1466 TO CUL DE SAC

TYPE OF WORK: THIN LIFT

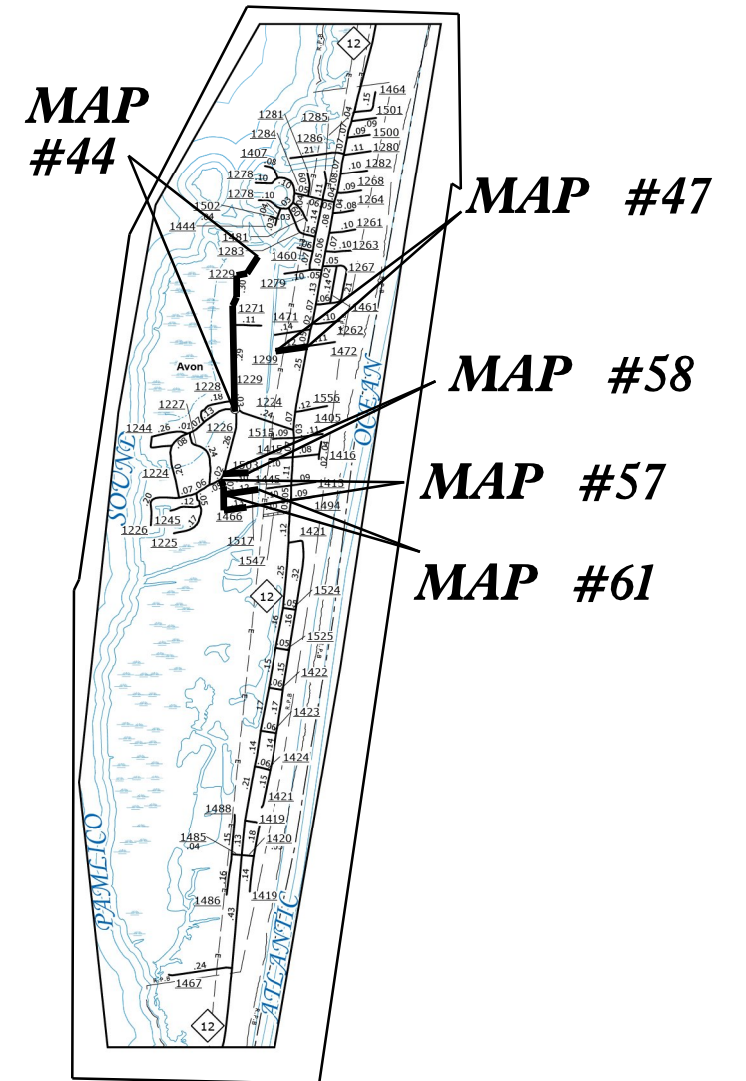

GRAPHIC SCALES

NTS

MAP LENGTH

- MAP #39 = 0.23 MILES
- MAP #42 = 0.45 MILES
- MAP #44 = 0.62 MILES
- MAP #47 = 0.11 MILES
- MAP #48 = 0.20 MILES
- MAP #54 = 0.05 MILES
- MAP #55 = 0.05 MILES
- MAP #57 = 0.20 MILES
- MAP #58 = 0.12 MILES
- MAP #61 = 0.12 MILES

Prepared in the Office of:
DIVISION OF HIGHWAYS
 113 Airport Dr., Edenton NC, 27932

2018 STANDARD SPECIFICATIONS	<p style="text-align: center;"> W. B. HOBBS, PE <small>DIVISION PROJECT TEAM LEAD</small> </p> <p style="text-align: center;"> CHRIS SLACHTA <small>DIVISION PROPOSALS ENGINEER</small> </p>
------------------------------	--

S. P. FENWICK, PLS
DIVISION DESIGN ENGINEER

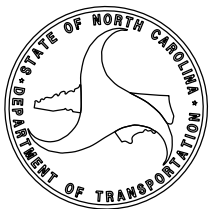

23-NOV-2021 12:10 S:\Contract\6161\Proposed Resurfacing\DA00504-Dare Secondary & Thin-Lift\Design Files\DA00504_DL.ddc.tshl-5.dgn
 \$\$\$USERNAME\$\$\$

09/08/99

CONTRACT: DA00504 WBS #: 2022CPT.01.10.20281.1, ETC.

STATE OF NORTH CAROLINA
DIVISION OF HIGHWAYS

DARE COUNTY

STATE	STATE PROJECT REFERENCE NO.	SHEET NO.
N.C.	2022CPT.01.10.20281.1, ETC.	5
STATE PROJ. NO.		DESCRIPTION
2022CPT.01.10.20281.1		PE, CONST
2022CPT.01.10.20282.1		PE, CONST

- LOCATION:**
- | | |
|--|--|
| MAP #9 - SR 1247 FROM NC 12 TO DEAD END | MAP #46 - SR 1290 FROM SR 1232 TO END PF MAINTENANCE |
| MAP #13 - SR 1292 FROM NC 12 TO SR 1508 | MAP #56 - SR 1406 FROM NC 12 TO END OF MAINTENANCE |
| MAP #18 - SR 1414 FROM NC 12 TO CUL DE SAC | MAP #59 - SR 1504 FROM CUL DE SAC TO NC 12 |
| MAP #25 - SR 1492 FROM DEAD END TO NC 12 | MAP #60 - SR 1507 FROM NC 12 TO END OF MAINTENANCE |
| MAP #26 - SR 1495 FROM CUL DE SAC TO NC 12 | MAP #61 - SR 1517 FROM SR 1466 TO CUL DE SAC |
| MAP #27 - SR 1498 FROM NC 12 TO DEAD END | MAP #62 - SR 1520 FROM SR 1504 TO END OF MAINTENANCE |
| MAP #28 - SR 1508 FROM CUL DE SAC TO SR 1509 | MAP #63 - SR 1523 FROM CUL DE SAC TO NC 12 |
| MAP #29 - SR 1509 FROM SR 1508 TO DEAD END | MAP #64 - SR 1539 FROM CUL DE SAC TO SR 1538 |
| MAP #30 - SR 1512 FROM NC 12 TO DEAD END | |
| MAP #31 - SR 1516 FROM NC 12 TO DEAD END | |
| MAP #34 - SR 1545 FROM SR 1508 TO CUL DE SAC | |
| MAP #45 - SR 1242 FROM END OF MAINTENANCE TO NC 12 | |

TYPE OF WORK: MILLING, RESURFACING, SHOULDER RECONSTRUCTION, & THIN LIFT

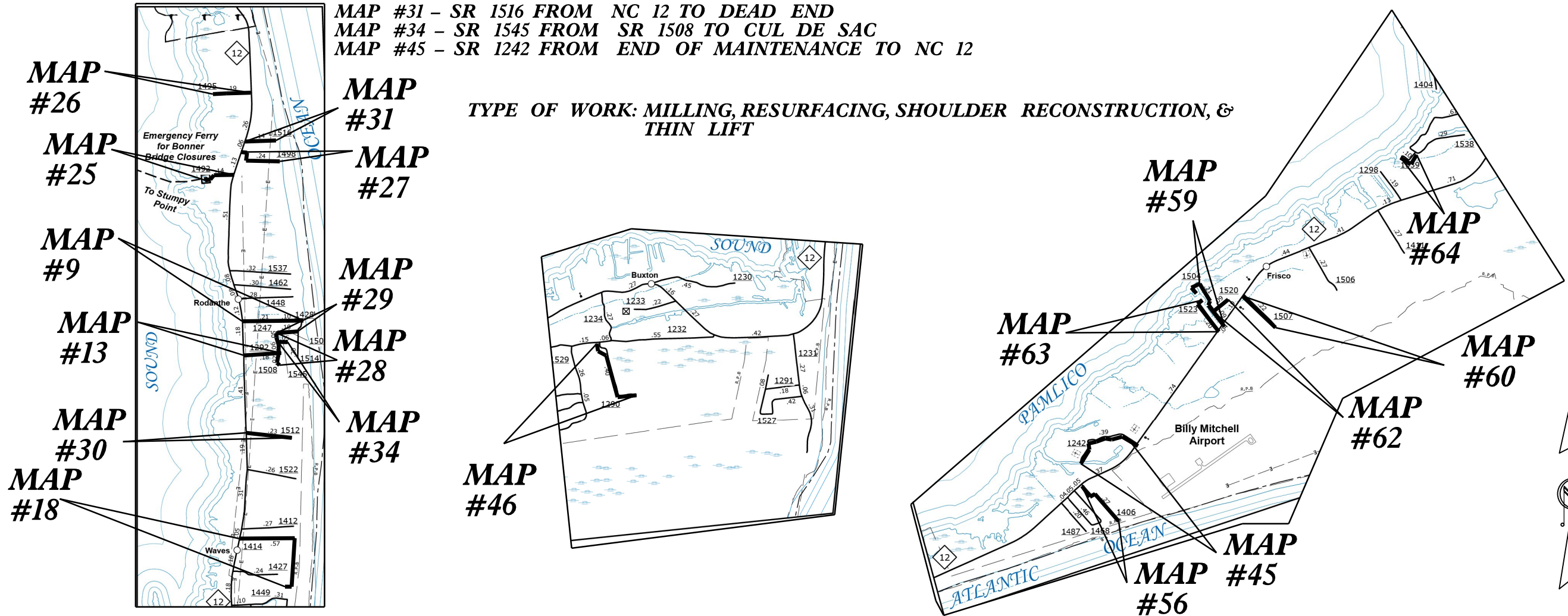

GRAPHIC SCALES

NTS

MAP LENGTH

MAP #9 = 0.30 MILES	MAP #34 = 0.05 MILES
MAP #13 = 0.18 MILES	MAP #45 = 0.27 MILES
MAP #18 = 0.56 MILES	MAP #46 = 0.44 MILES
MAP #25 = 0.14 MILES	MAP #56 = 0.27 MILES
MAP #26 = 0.19 MILES	MAP #59 = 0.30 MILES
MAP #27 = 0.24 MILES	MAP #60 = 0.22 MILES
MAP #28 = 0.21 MILES	MAP #62 = 0.09 MILES
MAP #29 = 0.10 MILES	MAP #63 = 0.20 MILES
MAP #30 = 0.26 MILES	MAP #64 = 0.10 MILES
MAP #31 = 0.14 MILES	

Prepared in the Office of:
DIVISION OF HIGHWAYS
113 Airport Dr., Edenton NC, 27932

2018 STANDARD SPECIFICATIONS

W. B. HOBBS, PE
DIVISION PROJECT TEAM LEAD

CHRIS SLACHTA
DIVISION PROPOSALS ENGINEER

S. P. FENWICK, PLS
DIVISION DESIGN ENGINEER

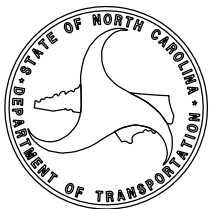

PAVEMENT SCHEDULE

C1	PROP. APPROX. 1.5" ASPHALT CONCRETE SURFACE COURSE, TYPE S9.5B, AT AN AVERAGE RATE OF 165 LBS. PER SQ. YD.
C2	PROP. APPROX. 1.0" ASPHALT CONCRETE SURFACE COURSE, TYPE S4.75A, AT AN AVERAGE RATE OF 110 LBS. PER SQ. YD.
U	EXISTING PAVEMENT.
T	EARTH MATERIAL
V1	MILLING ASPHALT PAVEMENT. 1.5" IN DEPTH.

NOTES:

- * ALL INTERSECTING ROADS ARE TO BE RESURFACED TO THE ENDS OF THEIR RADII, THE MAIN LINE RIGHT OF WAY OR AS DIRECTED BY THE ENGINEER. THIS SHALL INCLUDE ANY TAPERS AND TURN LANES LOCATED BOTH ON THE MAIN LINE OR INTERSECTING PAVED ROADWAY.
- * EDGES, PAVEMENT WIDENING, INTERSECTIONS AND BRIDGE FLARES ARE INCLUDED IN THE SUMMARY OF QUANTITIES

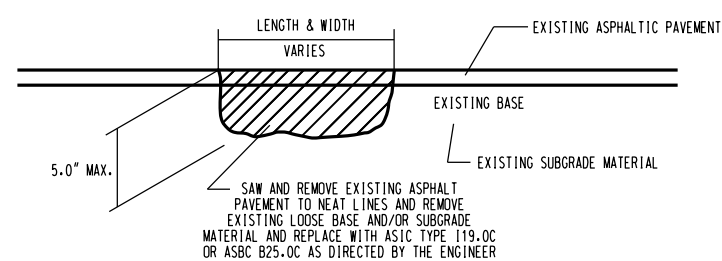
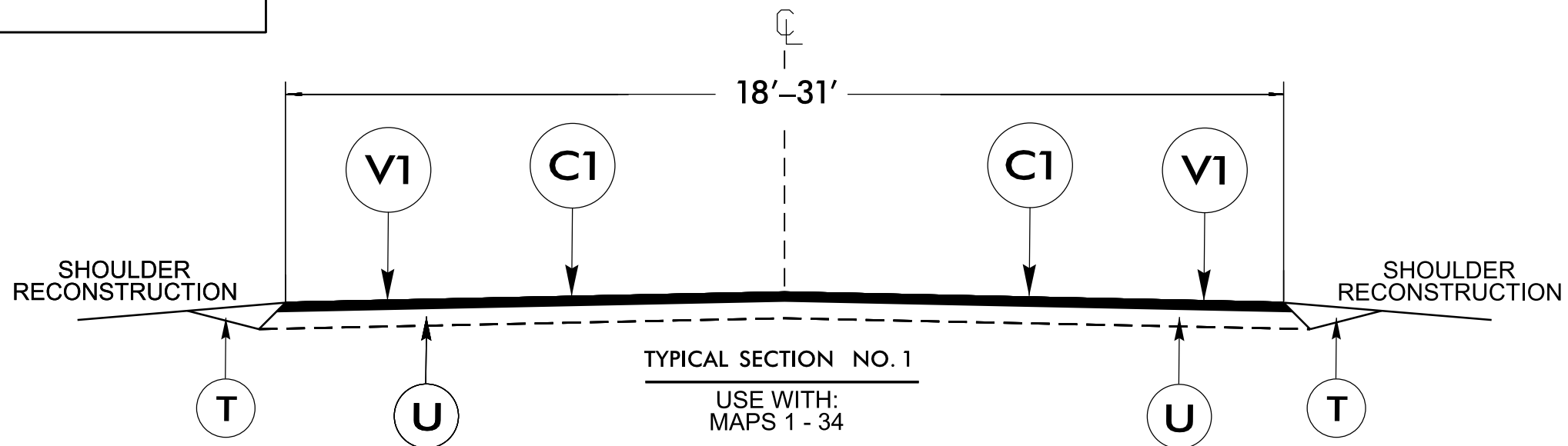

*NOTE: EDGES OF PATCHED AREA ARE TO BE CLEANED OF ALL DEBRIS AND COATED WITH AN APPROVED TACK MATERIAL BEFORE PLACING ASPHALT.

FULL DEPTH PATCHING, 0 - 5"

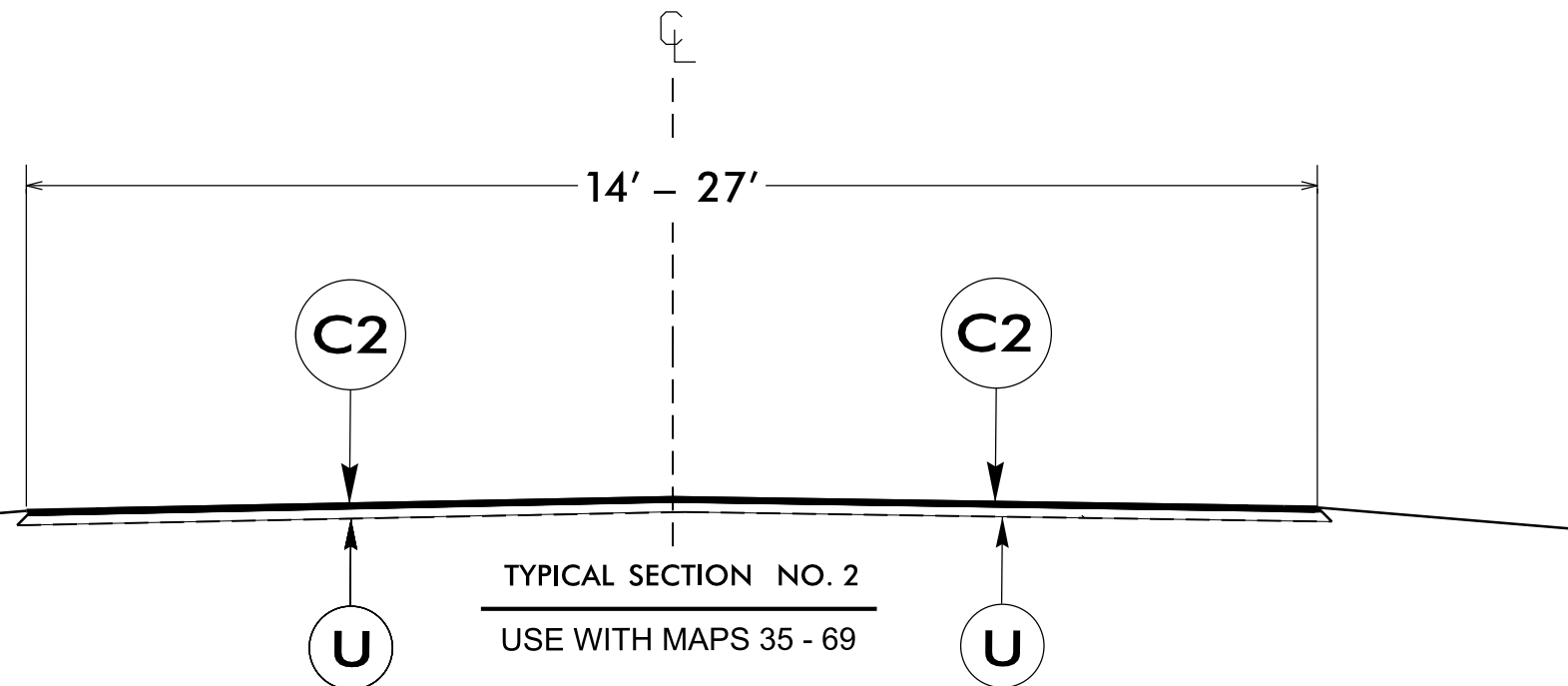

6/2/09
 30-NOV-2021 07:40
 S:\CONTRACTS\6161\Proposed Resurfacing\DA00504-Dore Secondary & Thin-Lift\Design Files\DA00504-DL-ddc-psh6-12.dgn
 30-NOV-2021 07:40
 S:\CONTRACTS\6161\Proposed Resurfacing\DA00504-Dore Secondary & Thin-Lift\Design Files\DA00504-DL-ddc-psh6-12.dgn

- NOTES:
- 1) DETAIL DOES NOT APPLY TO OGAFC AND ULTRA-THIN BONDED WEARING COURSE.
 - 2) BACKFILL SHOULDER WITH APPROVED MATERIAL.
 - 3) THE SHOULDER WEDGE DEVICE MAY BE DISENGAGED AT PAVED DRIVEWAYS AND SIDE STREETS.

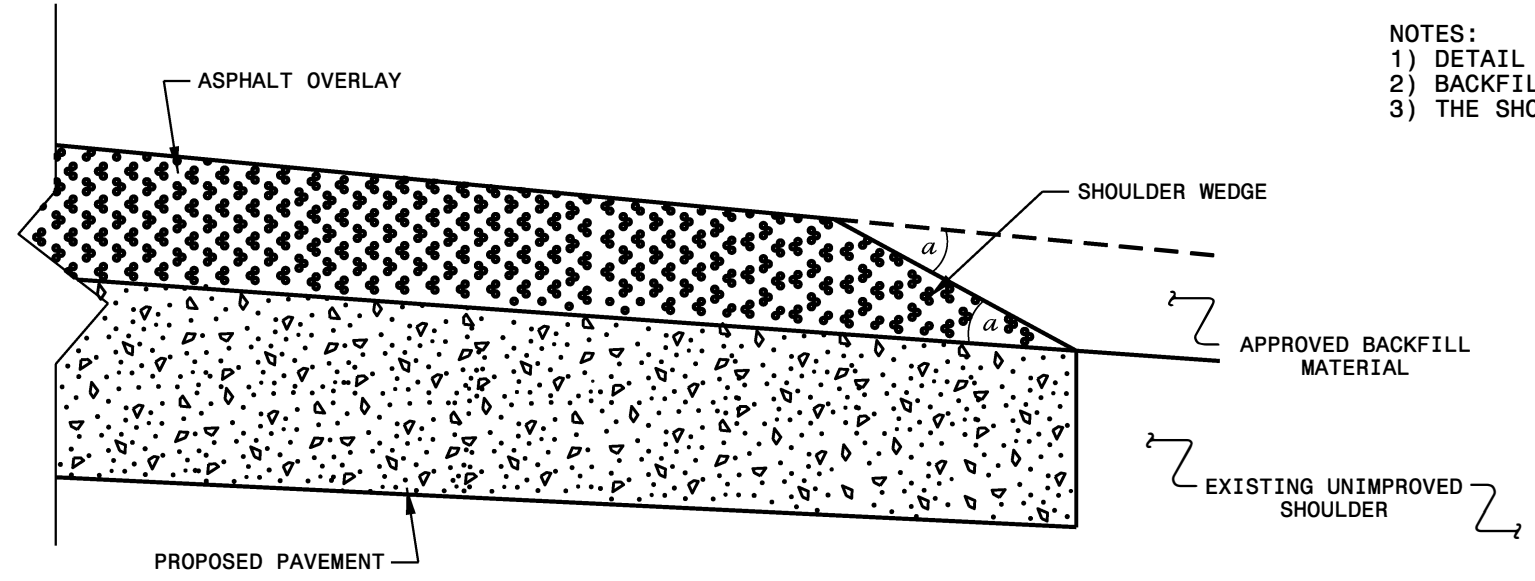

SHOULDER WEDGE DETAIL
 (Resurfacing Projects w/ Widening or
 with Existing Paved Shoulder having no dropoffs)

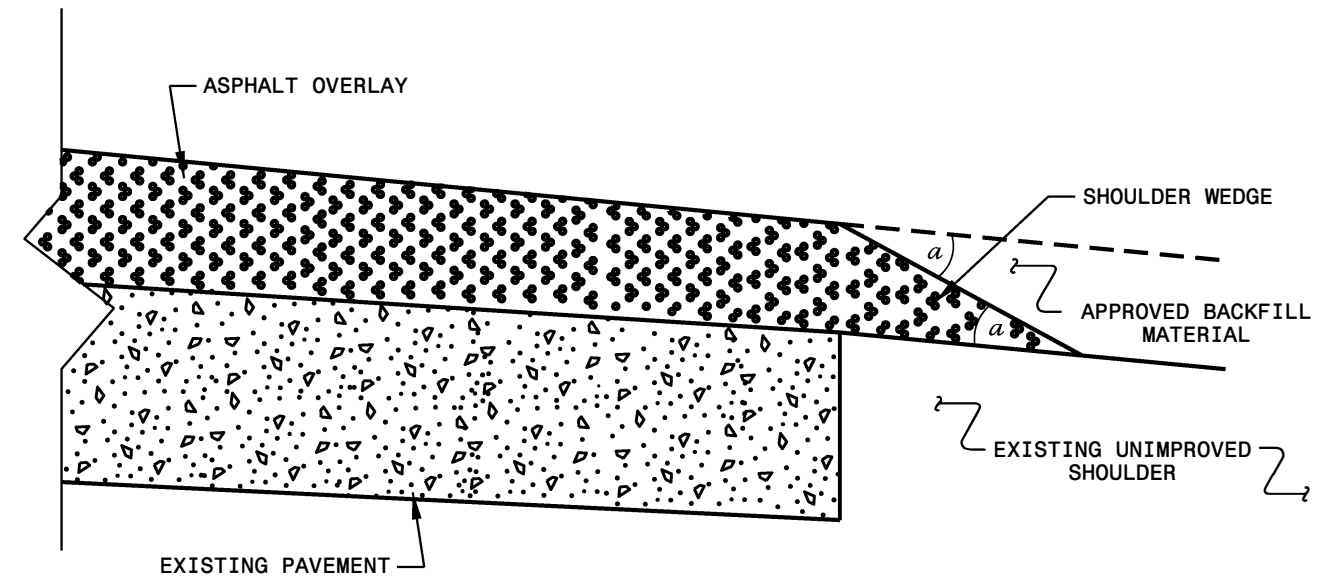

SHOULDER WEDGE DETAIL
 (Resurfacing Projects w/ NO Widening)

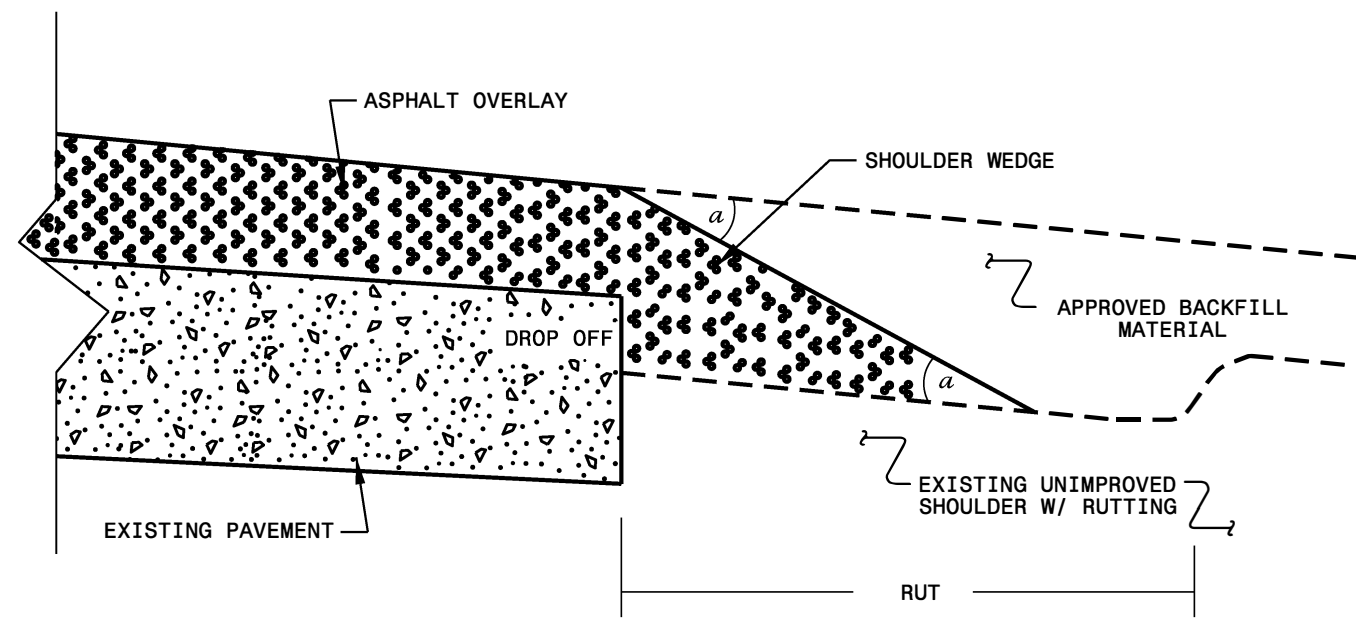



SHOULDER WEDGE DETAIL
 (Resurfacing Adjacent to
 Rutted Shoulder)

- SHOULDER WEDGE ANGLE = 30°

CONTRACT STANDARDS AND DEVELOPMENT UNIT			
Office 919-707-6950		FAX 919-250-4119	
SHOULDER WEDGE DETAILS			
ORIGINAL BY:	T.SPELL	DATE:	7-19-11
MODIFIED BY:		DATE:	10/16/12
CHECKED BY:		DATE:	
FILE SPEC.:	s:\usr\details\stand\shoulderwedgedetail.dgn		





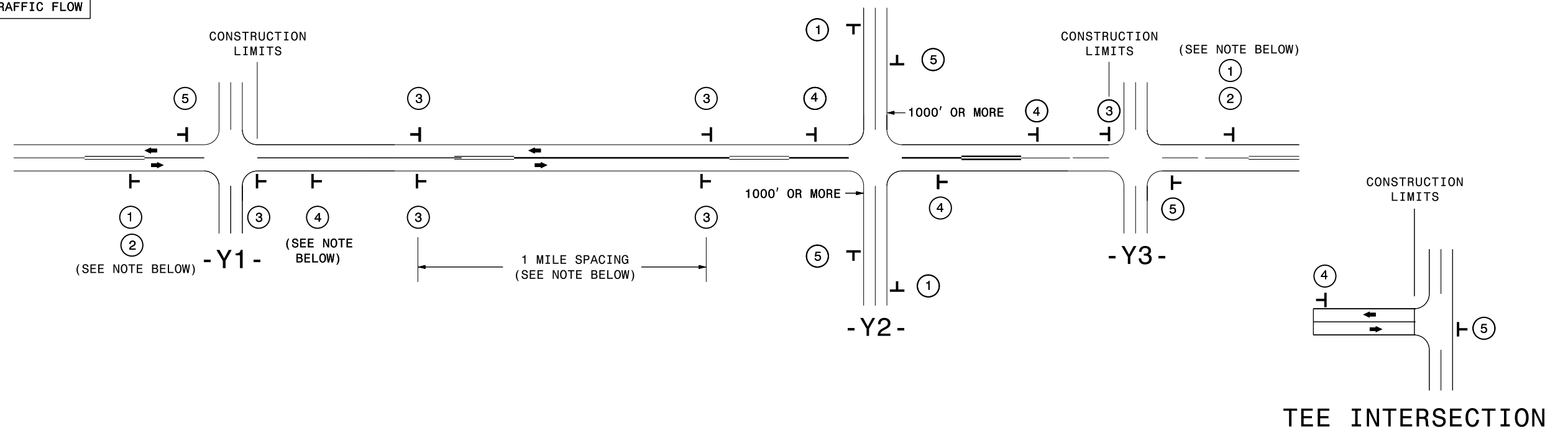

SIGNING FOR RESURFACING PROJECTS

LEGEND
 STATIONARY SIGN
 DIRECTION OF TRAFFIC FLOW

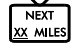

MAINLINE (-L-) SIGNING

-Y- LINE SIGNING

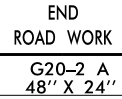
SIGNING NOTES AND PLACEMENT PER DIRECTION	<p>①  W20-1 48" X 48"</p> <p>②  W7-3aP 24" X 18"</p>	<p>PLACE 1000' PRIOR TO BEGINNING OF CONSTRUCTION LIMITS. ONLY USED ON -Y- LINES IF RESURFACING LIMITS EXTEND 1000' ALONG -Y- LINE.</p> <p>#2 SIGN ONLY USED WHEN CONSTRUCTION LIMITS ARE 2 OR MORE MILES IN LENGTH. ROUND UP TO NEXT WHOLE NUMBER. (NO FRACTIONAL OR DECIMAL NUMBERS)</p>	<p>NO REQUIRED STATIONARY SIGNING FOR THE FOLLOWING -Y- LINE CONDITIONS:</p> <ol style="list-style-type: none"> 1) LESS THAN 1000' OF RESURFACING ALONG -Y- LINE 2) SUBDIVISION ROADS 3) DEAD END ROADS <p>WHEN PAVING/CONSTRUCTION ACTIVITIES PROCEED ACROSS AN UNSIGNED -Y- LINE, PORTABLE ADVANCE WARNING SIGNS SHALL BE USED ALONG THE -Y- LINE AS SHOWN BELOW. REMOVE UPON COMPLETION OF WORK.</p> <div style="display: flex; justify-content: space-around;"> <div style="text-align: center;">  W20-1 48" X 48" PLACED 500' IN ADVANCE OF FLAGGER. </div> <div style="text-align: center;">  W20-7 A 48" X 48" </div> </div>
	<p>③  SP 13107 48" X 48"</p> <p> SP 48" X 48"</p>	<p>- PLACE INITIALLY AT THE CONSTRUCTION LIMITS AND SPACE 1 MILE APART THEREAFTER.</p> <p>- AT TEE INTERSECTIONS INSTALL INITIALLY 1/2 MILE FROM INTERSECTION AND SPACE 1 MILE APART THEREAFTER.</p>	
	<p>④  SP 13106 48" X 48"</p>	<p>- THESE ARE FOR -Y- LINES THAT ARE "THROUGH" ROADWAYS.</p> <p>- DEAD END AND SUBDIVISION ROADS ARE NOT "THROUGH" ROADWAYS.</p> <p>- INSTALL 500' +/- FROM EACH -Y- LINE APPROACH AS SHOWN ABOVE.</p> <p>- FOR MULTIPLE -Y- LINES THAT ARE SEPARATED BY 0.25 MILES OR LESS, TREAT AS A SINGLE UNIT AND INSTALL WITHIN 500' OF EACH APPROACH.</p> <p>- A MAXIMUM OF 2 SIGN SETS PER MILE. DO NOT INSTALL WHEN -Y- LINES ARE WITHIN 0.5 MILES FROM "END ROAD WORK" SIGN.</p> <p>- FOR TEE INTERSECTIONS, INSTALL WITHIN 500' +/- OF THE INTERSECTION ALONG -L- LINE.</p>	
	<p>⑤  G20-2 A 48" X 24"</p>	<p>PLACE 500' FOLLOWING THE END OF CONSTRUCTION LIMITS OR AS SHOWN WHEN WORK ENDS AT A 3-WAY TEE INTERSECTION.</p>	
	<p>THE ABOVE SIGNS ARE ALL THAT ARE REQUIRED FOR A CONTRACTOR TO BEGIN A RESURFACING CONTRACT. ANY ADDITIONAL SIGNS REQUESTED BY NCDOT DIVISIONS SHALL BE INSTALLED WITHIN 7 BUSINESS DAYS OF THE START OF CONTRACT WORK.</p>		
<p>MAPS LESS THAN 2 MILES</p>	<p>FOR RESURFACING MAPS WITH CONSTRUCTION LIMITS LESS THAN 2 MILES IN LENGTH, NO STATIONARY SIGNS ARE REQUIRED. USE PORTABLE "ROAD UNDER CONSTRUCTION" OR "ROAD WORK AHEAD" SIGNS IN LIEU OF STATIONARY ADVANCE WARNINGS SIGNS.</p>		

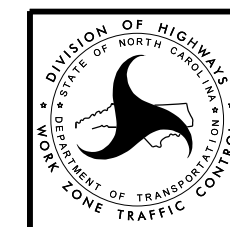

ADVANCE WARNING SIGNS FOR RURAL AND SUBURBAN 2-LANE ROADWAY RESURFACING

NOTES: Less than 5' - 10' undisturbed buffer from ROW, ditchline, water feature, or drainage inlet, add BMP.

BMP Options: Wattle or Silt Fence

EROSION CONTROL DETAIL

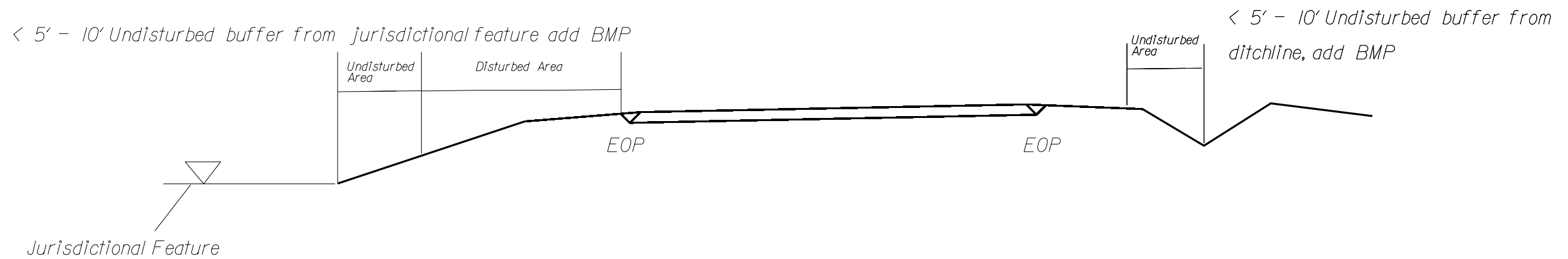
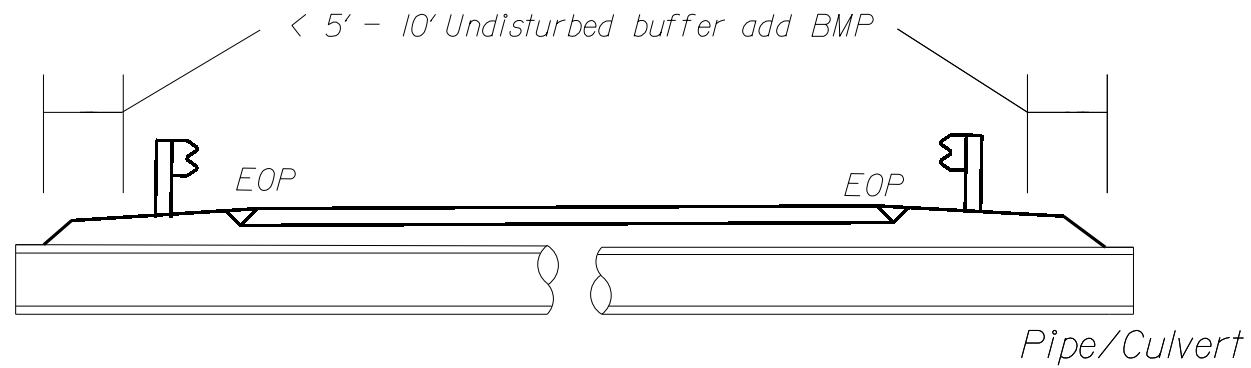

Use BMP's if shoulders and/or frontslopes and/or ditchline and/or backslopes are disturbed



< 5' - 10' Undisturbed buffer from inlet, add wattle

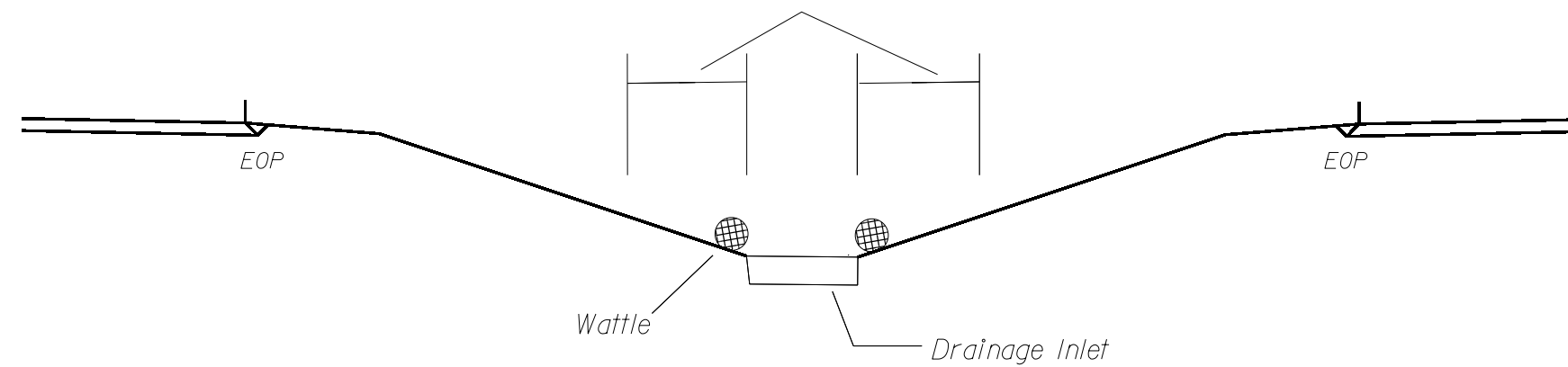

NOT TO SCALE

COIR FIBER WATTLE DETAIL

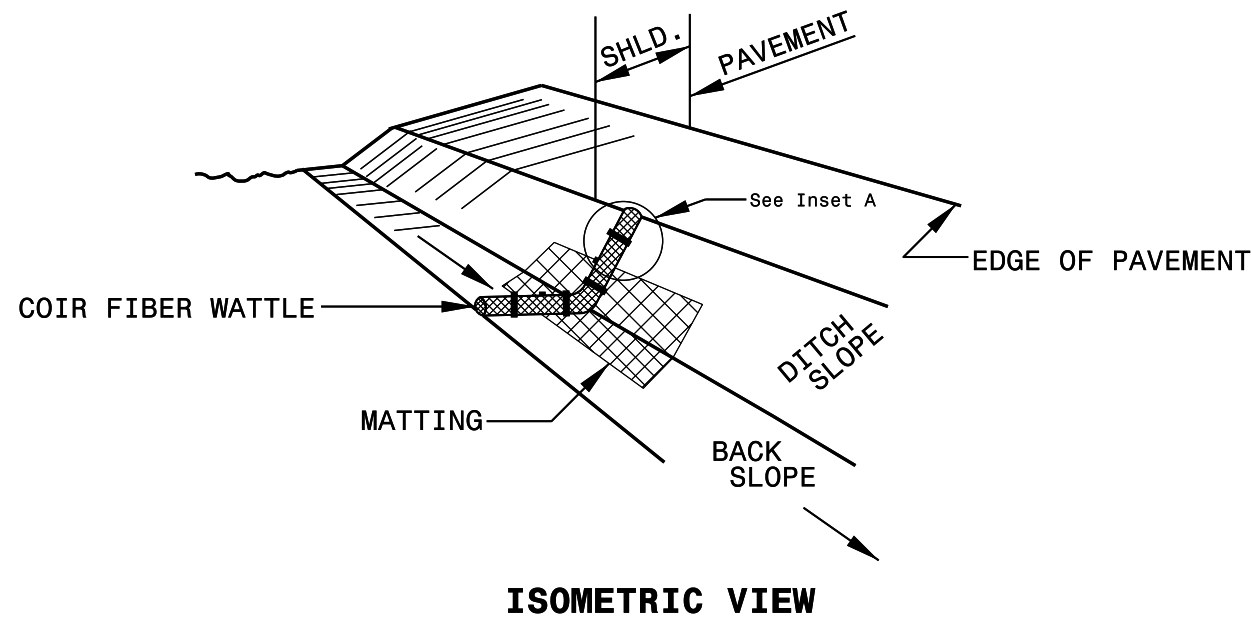

NOTES:

USE MINIMUM 12 IN. DIAMETER COIR FIBER (COCONUT FIBER) WATTLE.

USE 2 FT. WOODEN STAKES WITH A 2 IN. BY 2 IN. NOMINAL CROSS SECTION.

ONLY INSTALL WATTLE(S) TO A HEIGHT IN DITCH SO FLOW WILL NOT WASH AROUND WATTLE AND SCOUR DITCH SLOPES AND AS DIRECTED.

INSTALL A MINIMUM OF 2 UPSLOPE STAKES AND 4 DOWNSLOPE STAKES AT AN ANGLE TO WEDGE WATTLE TO BOTTOM OF DITCH.

PROVIDE STAPLES MADE OF 0.125 IN. DIAMETER STEEL WIRE FORMED INTO A U SHAPE NOT LESS THAN 12" IN LENGTH.

INSTALL STAPLES APPROXIMATELY EVERY 1 LINEAR FOOT ON BOTH SIDES OF WATTLE AND AT EACH END TO SECURE IT TO THE SOIL.

INSTALL MATTING IN ACCORDANCE WITH SECTION 1631 OF THE STANDARD SPECIFICATIONS.

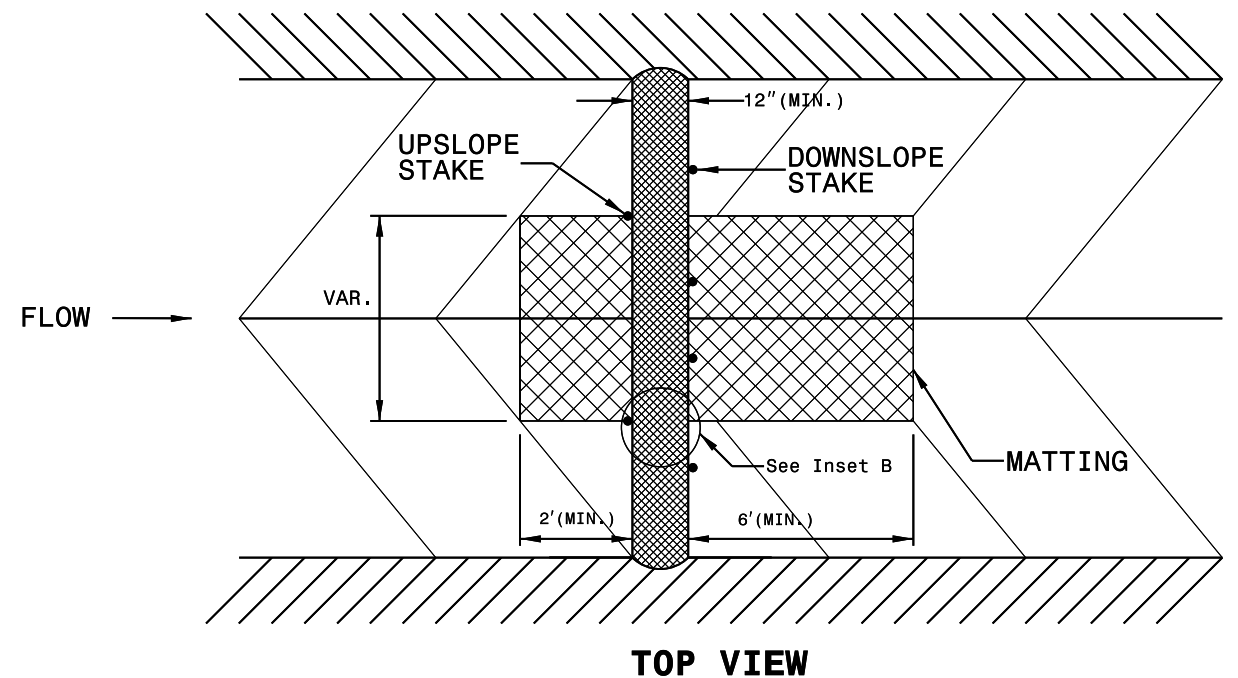
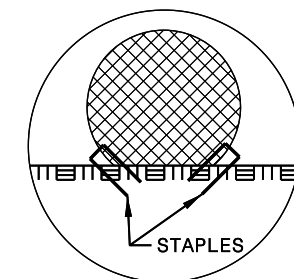
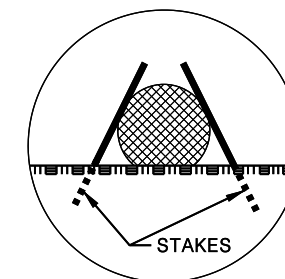
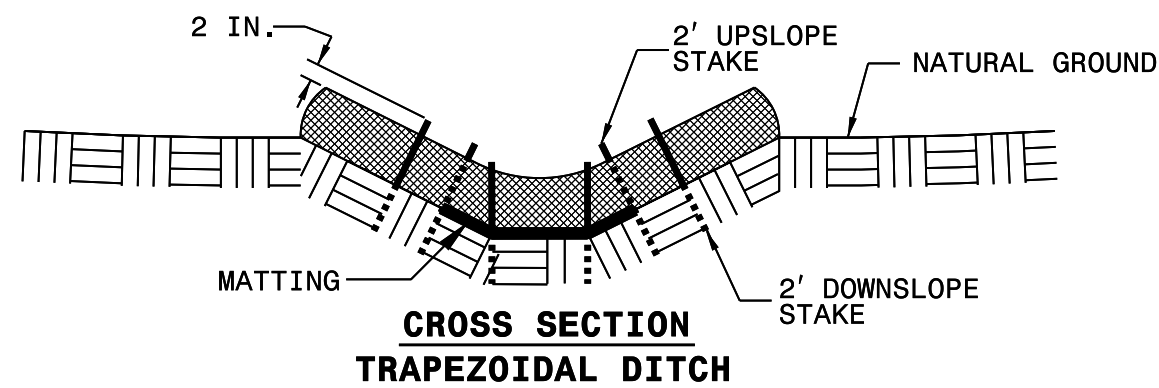
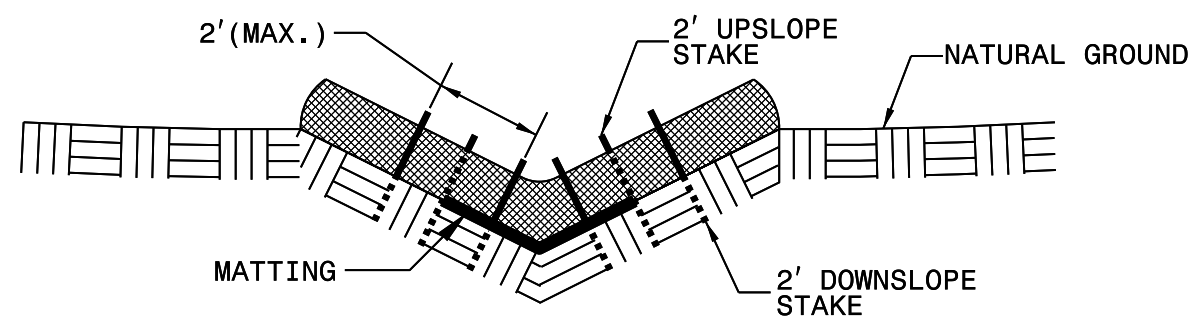

DIVISION OF HIGHWAYS
STATE OF NORTH CAROLINA

SOIL STABILIZATION TIMEFRAMES

<i>SITE DESCRIPTION</i>	<i>STABILIZATION TIME</i>	<i>TIMEFRAME EXCEPTIONS</i>
PERIMETER DIKES, SWALES, DITCHES AND SLOPES	7 DAYS	NONE
HIGH QUALITY WATER (HQW) ZONES	7 DAYS	NONE
SLOPES STEEPER THAN 3:1	7 DAYS	IF SLOPES ARE 10' OR LESS IN LENGTH AND ARE NOT STEEPER THAN 2:1, 14 DAYS ARE ALLOWED.
SLOPES 3:1 OR FLATTER	14 DAYS	7 DAYS FOR SLOPES GREATER THAN 50' IN LENGTH.
ALL OTHER AREAS WITH SLOPES FLATTER THAN 4:1	14 DAYS	NONE, EXCEPT FOR PERIMETERS AND HQW ZONES.